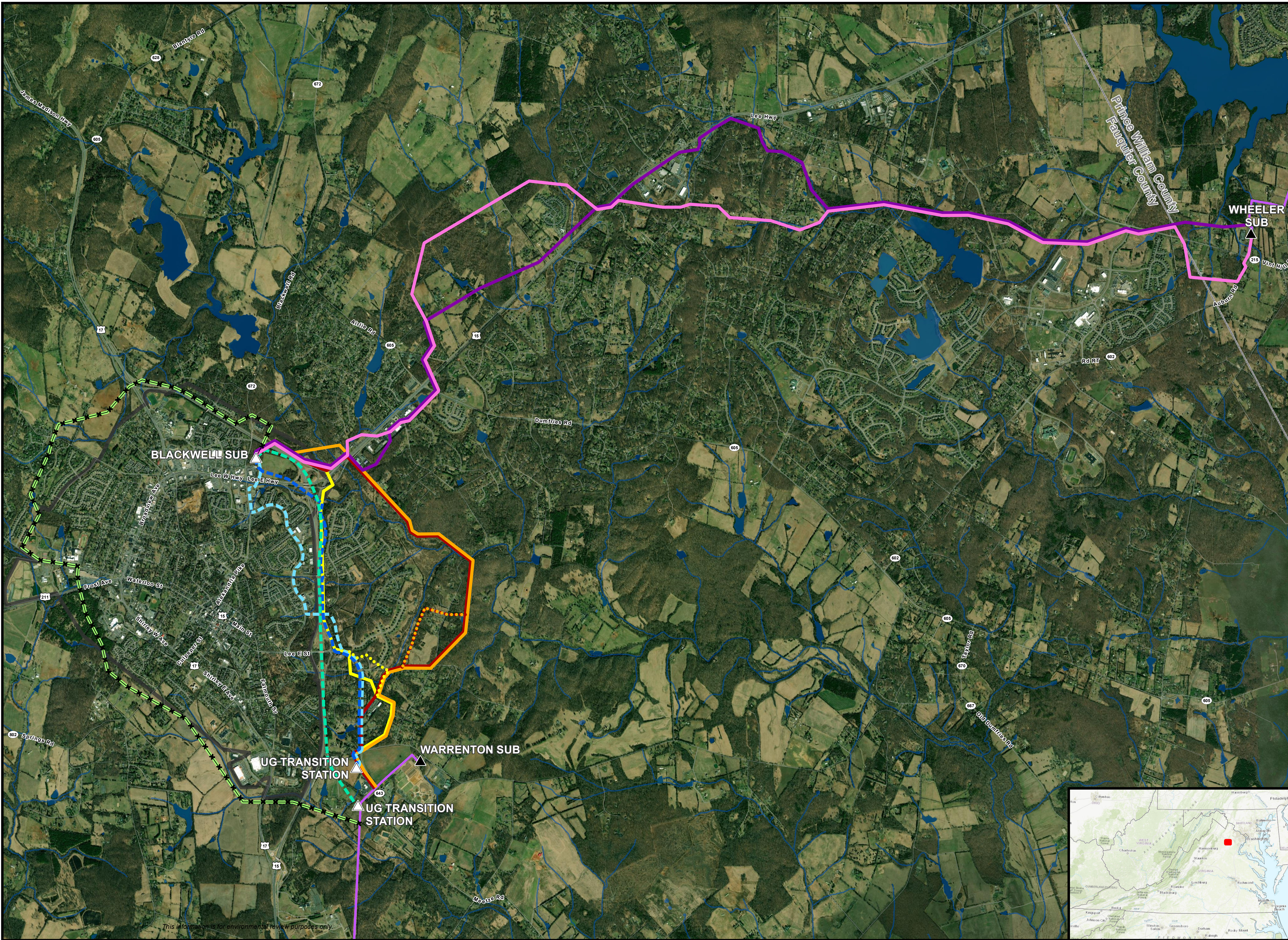
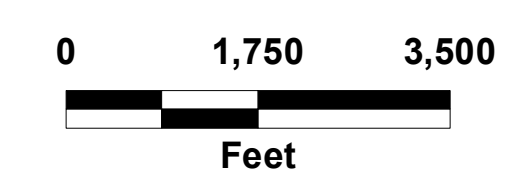
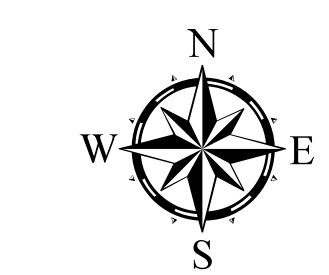


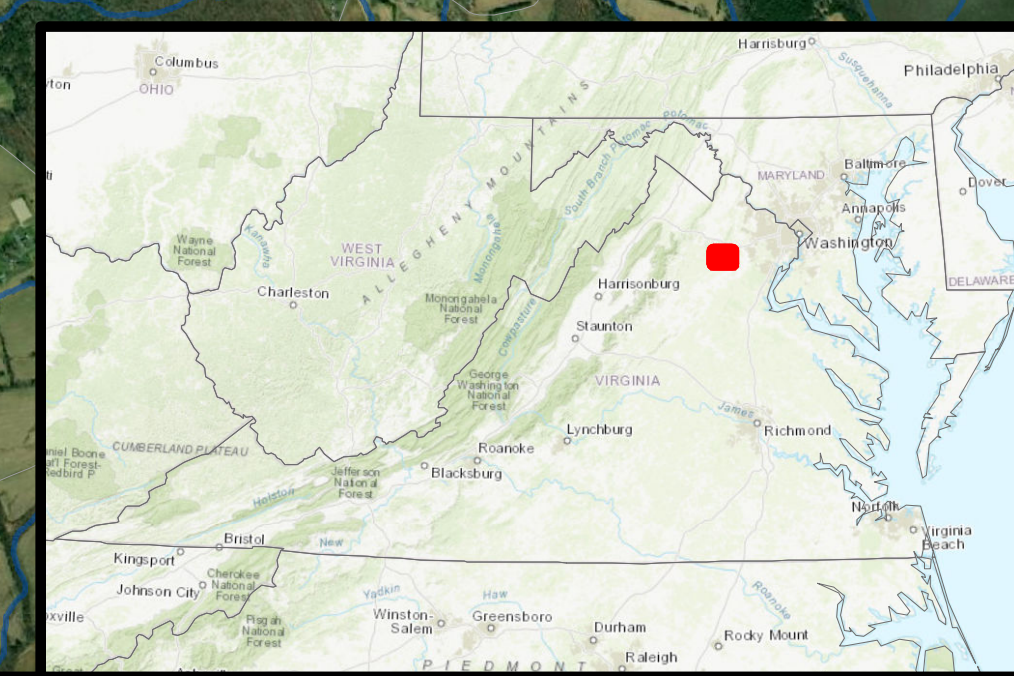
**Figure 1**  
**Overview Map**  
 Blackwell Rd 230 kV Transmission  
 Line and Substation Project  
 Fauquier and Prince William  
 Counties, Virginia



- Existing Substation
- Proposed Substation or Transition Station
- Option 1, Overhead Route 1
- Option 1, Overhead Route 2
- Option 1, Overhead Route 3
- Option 1, Overhead Route 4
- Option 1, Underground Route 1
- Option 1, Underground Route 2
- Option 1, Underground Route 3
- Option 2, Overhead Route 1
- Option 2, Overhead Route 2
- Option 1, Overhead Route 1 Variation
- Option 1, Overhead Route 2 Variation
- Option 1, Overhead Route 3 Variation
- Route Considered But Rejected
- Existing Dominion Transmission Line
- NHD Waterbody
- Town of Warrenton Municipal Boundary
- County Boundary



1:21,000

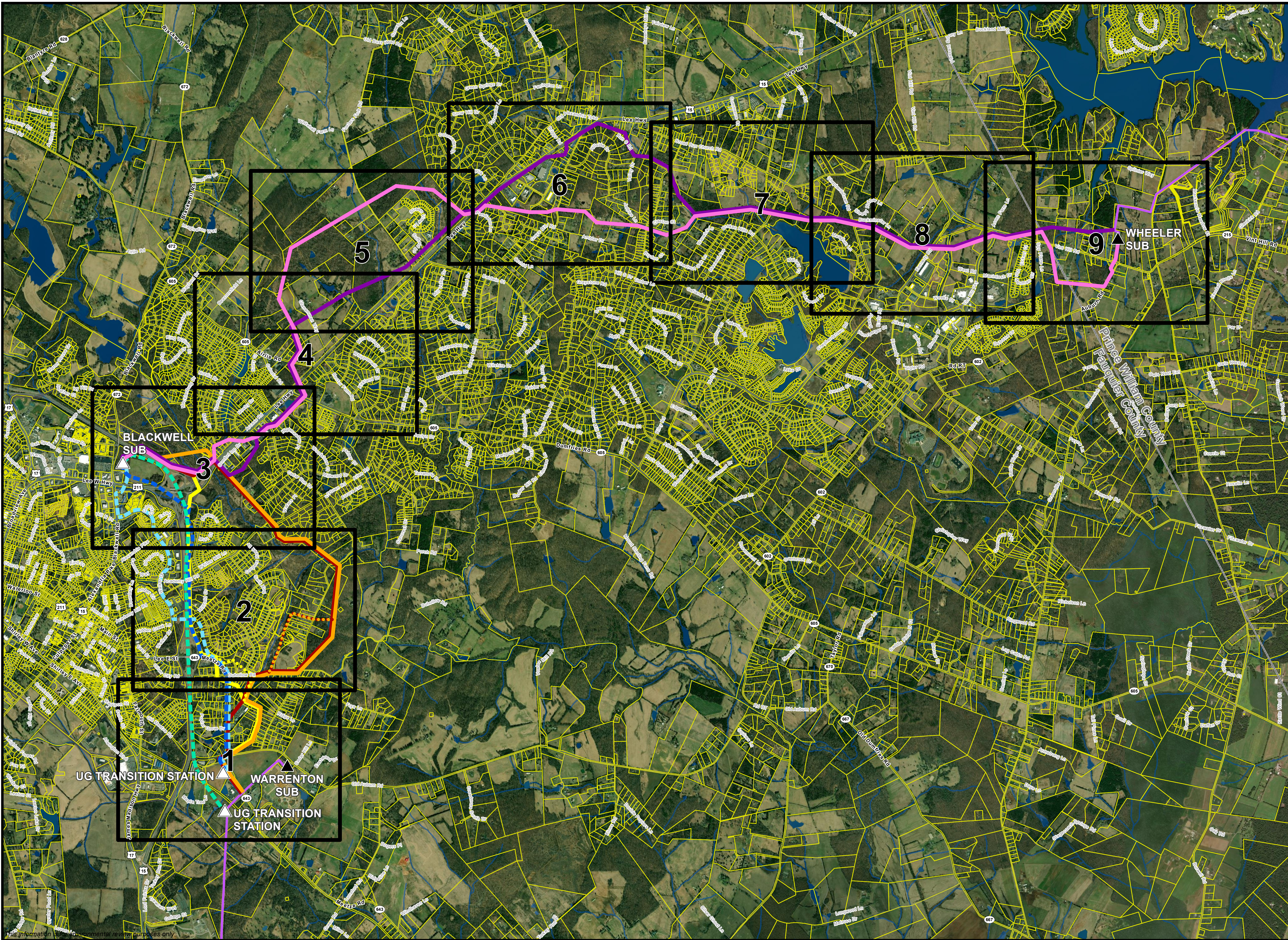


*This information is for environmental review purposes only.*

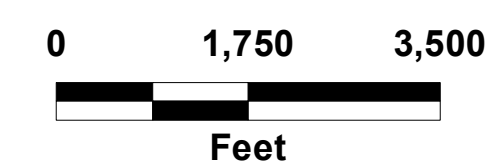
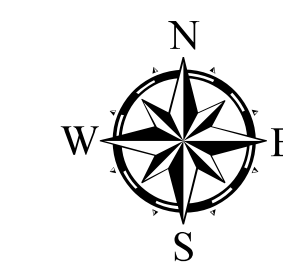
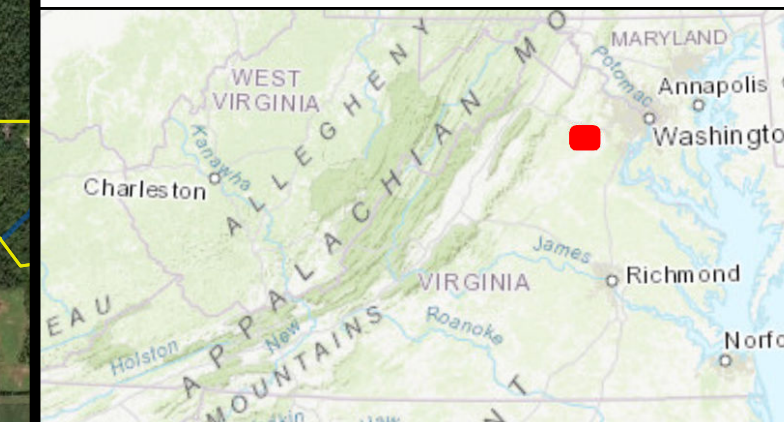




**Figure 1**  
**Parcel Index Map**  
**Blackwell Rd 230 kV Transmission**  
**Line and Substation Project**  
**Fauquier and Prince William**  
**Counties, Virginia**



- Page Index
- Existing Substation
- Proposed Substation or Transition Station
- Option 1, Overhead Route 1
- Option 1, Overhead Route 2
- Option 1, Overhead Route 3
- Option 1, Underground Route 1
- Option 1, Underground Route 2
- Option 1, Underground Route 3
- Option 2, Overhead Route 1
- Option 2, Overhead Route 2
- Option 1, Overhead Route 1 Variation
- Option 1, Overhead Route 2 Variation
- Option 1, Overhead Route 3 Variation
- Existing Dominion Transmission Line
- Parcel Boundary
- Town of Warrenton Municipal Boundary
- NHD Waterbody



1:21,000

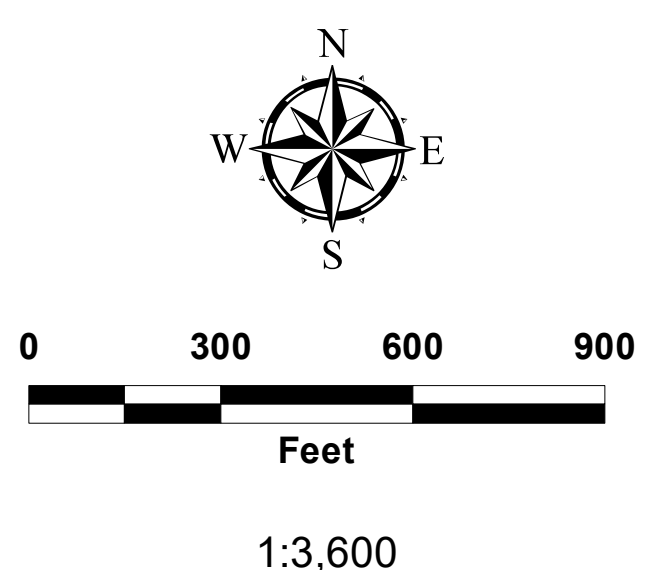
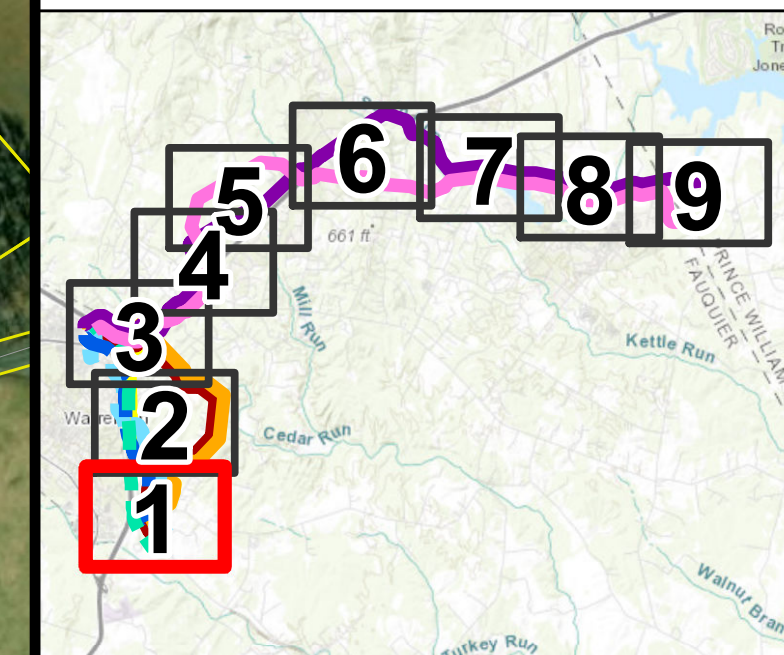




**Figure 2**  
**Parcel Map Set**  
**Blackwell Rd 230 kV Transmission**  
**Line and Substation Project**  
**Fauquier and Prince William**  
**Counties, Virginia**  
**Page 1**



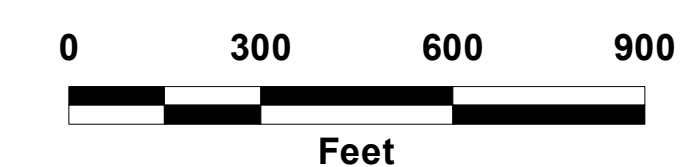
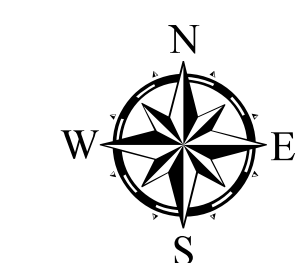
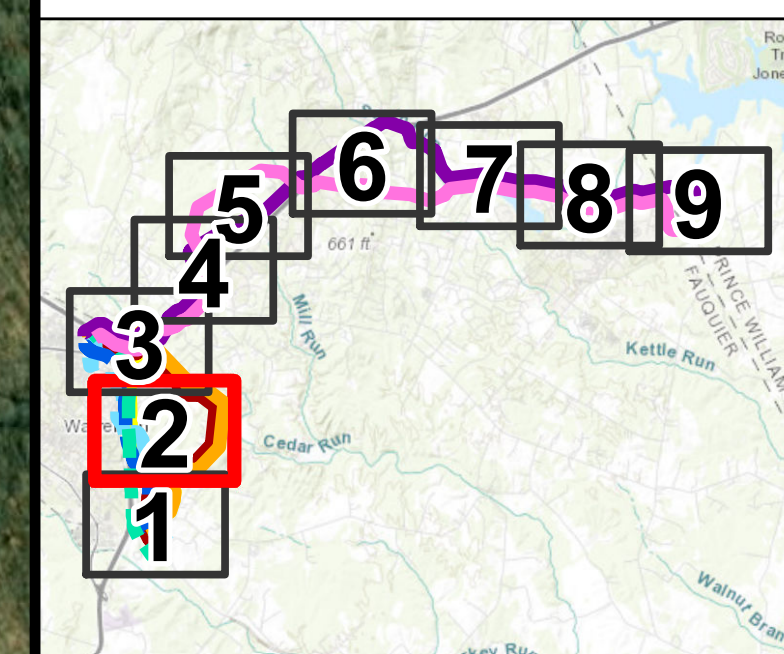
- Existing Substation
- Proposed Substation or Transition Station
- Option 1, Overhead Route 1
- Option 1, Overhead Route 2
- Option 1, Overhead Route 3
- Option 1, Underground Route 1
- Option 1, Underground Route 2
- Option 1, Underground Route 3
- Option 1, Overhead Route 3 Variation
- Proposed Overhead Right of Way
- Proposed Underground Right of Way
- Variation Overhead Right of Way
- Existing Dominion Transmission Line
- Parcel Boundary
- Town of Warrenton Municipal Boundary
- NHD Waterbody





**Figure 2**  
**Parcel Map Set**  
**Blackwell Rd 230 kV Transmission**  
**Line and Substation Project**  
**Fauquier and Prince William**  
**Counties, Virginia**  
**Page 2**

- Option 1, Overhead Route 1
- Option 1, Overhead Route 2
- Option 1, Overhead Route 3
- - - Option 1, Underground Route 1
- - - Option 1, Underground Route 2
- - - Option 1, Underground Route 3
- Option 1, Overhead Route 1 Variation
- Option 1, Overhead Route 2 Variation
- Option 1, Overhead Route 3 Variation
- Proposed Overhead Right of Way
- Proposed Underground Right of Way
- Variation Overhead Right of Way
- Parcel Boundary
- Town of Warrenton Municipal Boundary
- NHD Waterbody

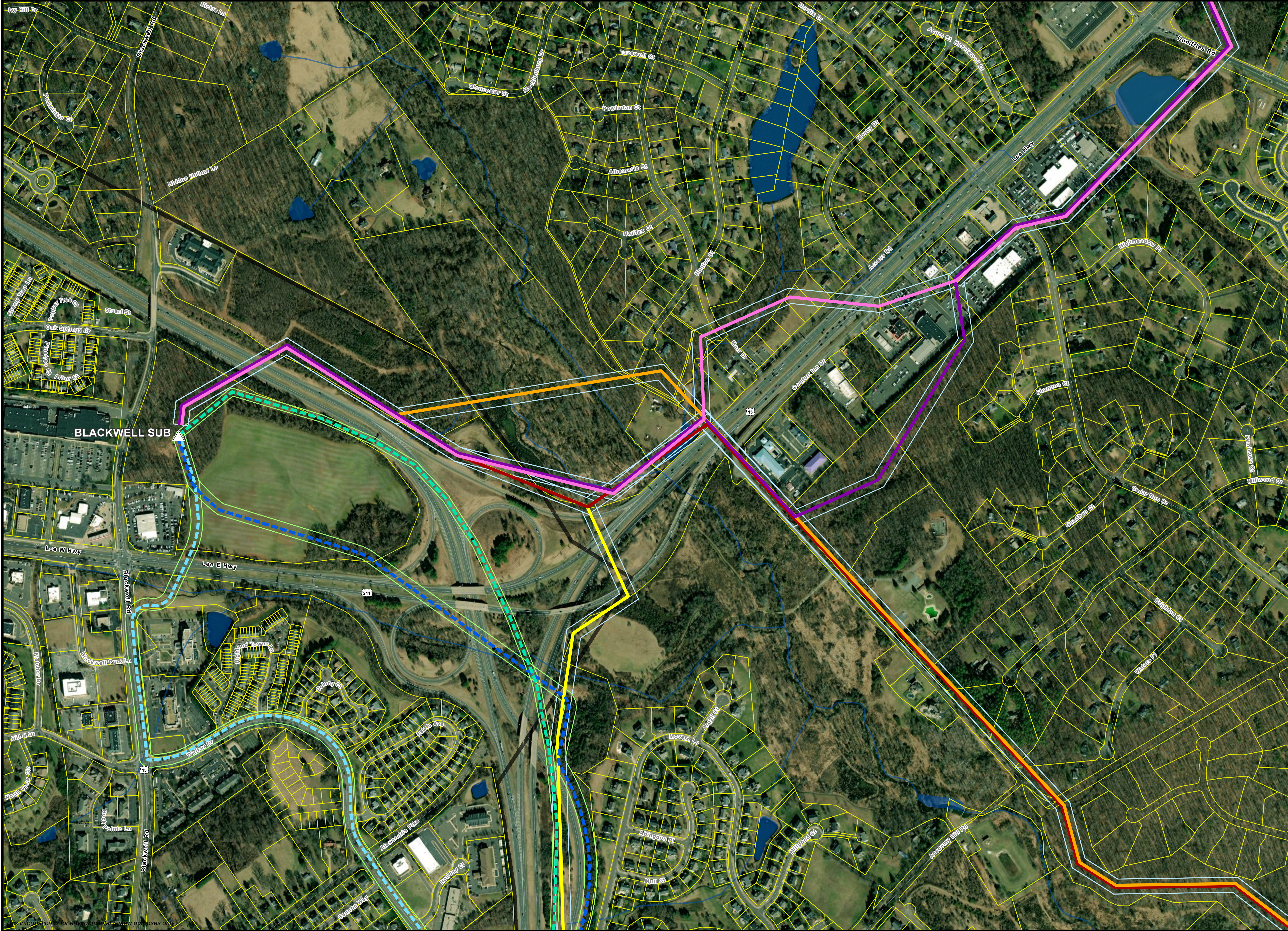


1:3,600

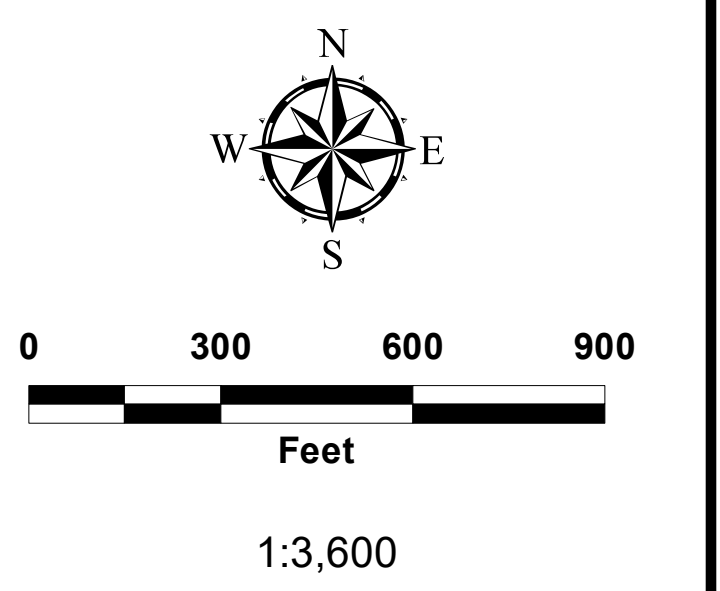
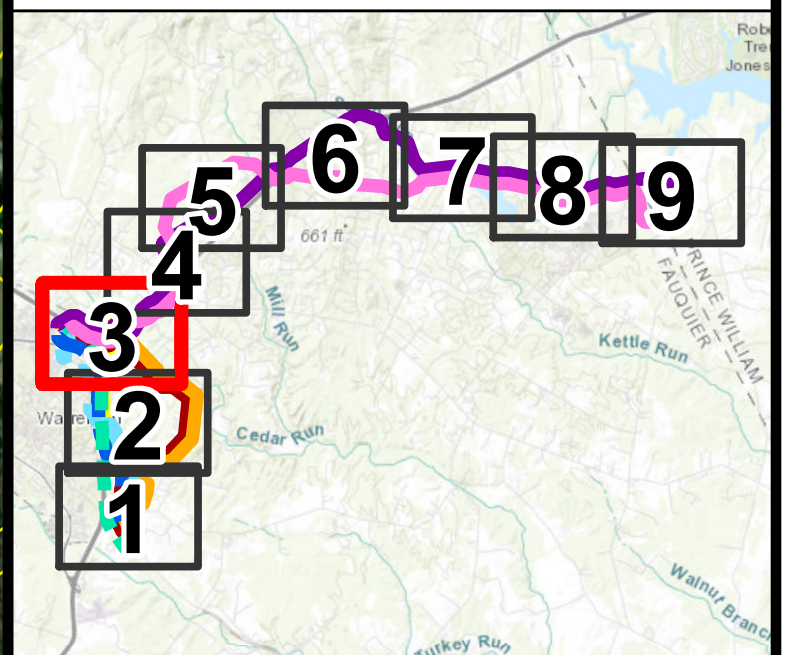




**Figure 2**  
**Parcel Map Set**  
**Blackwell Rd 230 kV Transmission**  
**Line and Substation Project**  
**Fauquier and Prince William**  
**Counties, Virginia**  
**Page 3**



- Proposed Substation or Transition Station
- Option 1, Overhead Route 1
- Option 1, Overhead Route 2
- Option 1, Overhead Route 3
- Option 1, Underground Route 1
- Option 1, Underground Route 2
- Option 1, Underground Route 3
- Option 2, Overhead Route 1
- Option 2, Overhead Route 2
- Proposed Overhead Right of Way
- Proposed Underground Right of Way
- Parcel Boundary
- Town of Warrenton Municipal Boundary
- NHD Waterbody

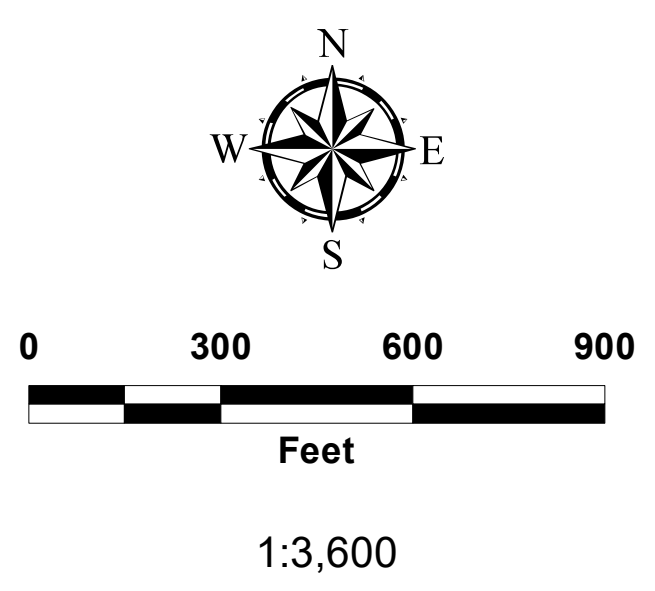
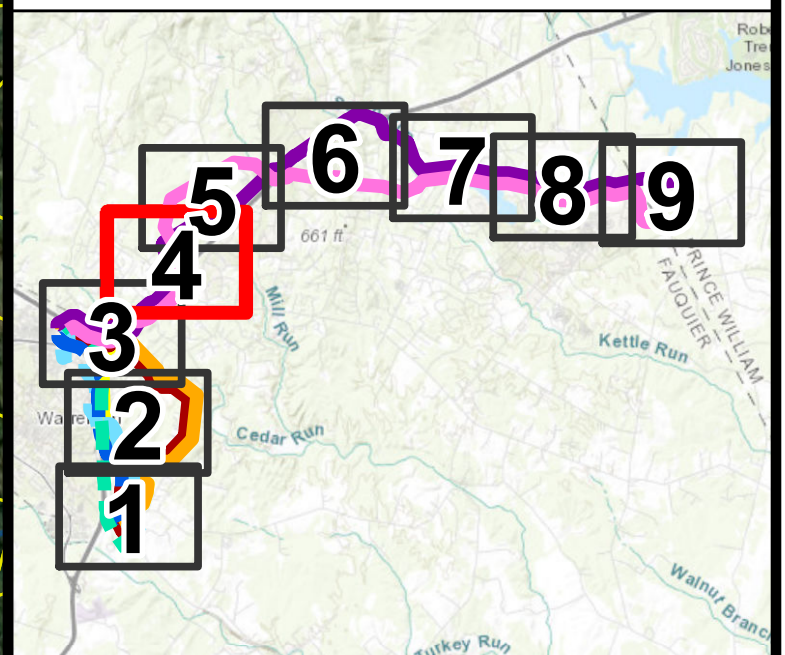




**Figure 2**  
**Parcel Map Set**  
 Blackwell Rd 230 kV Transmission  
 Line and Substation Project  
 Fauquier and Prince William  
 Counties, Virginia  
 Page 4



- Option 2, Overhead Route 1
- Option 2, Overhead Route 2
- Proposed Overhead Right of Way
- Parcel Boundary
- NHD Waterbody

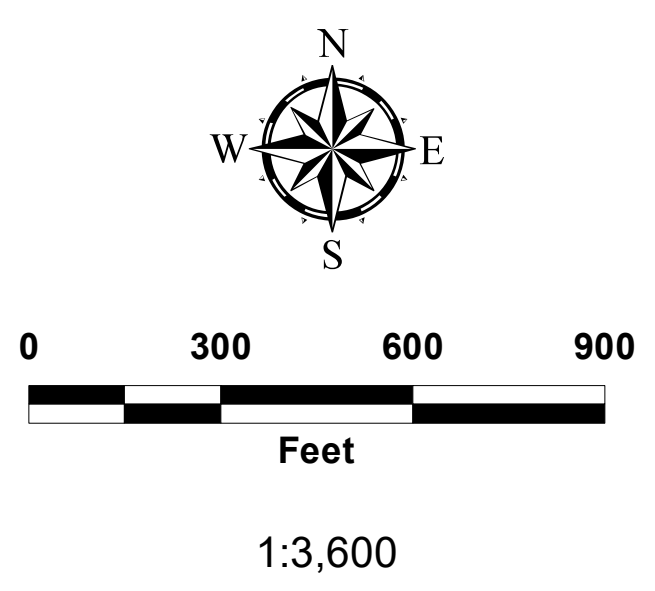
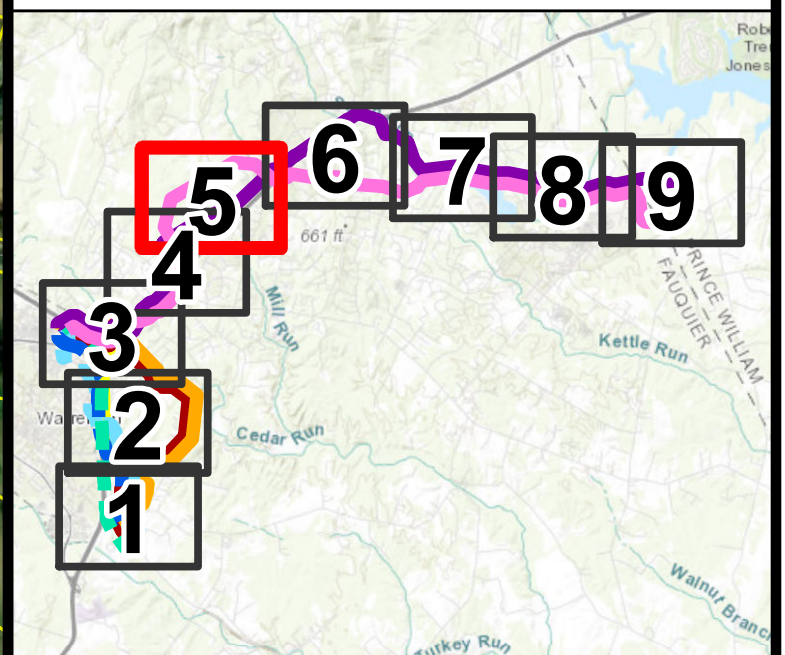




**Figure 2**  
**Parcel Map Set**  
 Blackwell Rd 230 kV Transmission  
 Line and Substation Project  
 Fauquier and Prince William  
 Counties, Virginia  
 Page 5



- Option 2, Overhead Route 1
- Option 2, Overhead Route 2
- Proposed Overhead Right of Way
- Parcel Boundary
- NHD Waterbody

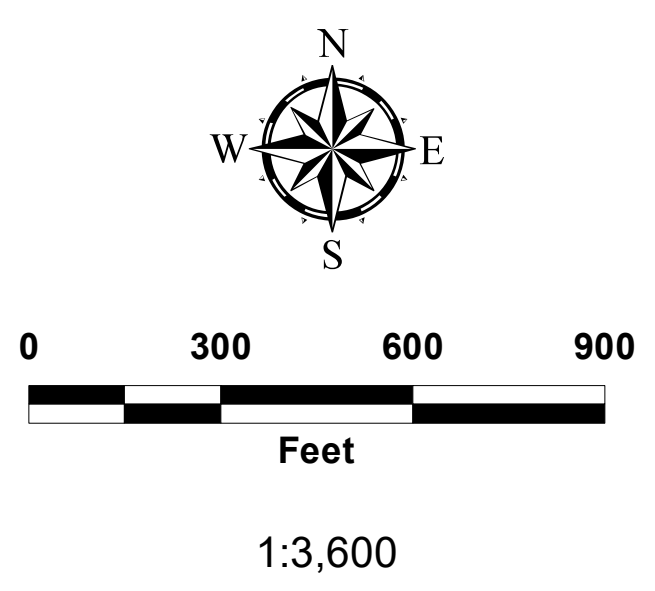
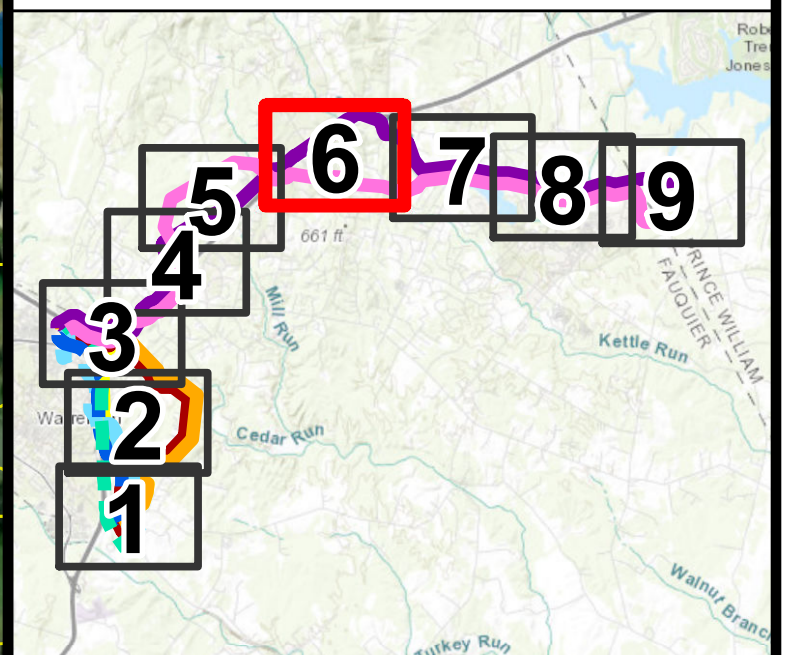




**Figure 2**  
**Parcel Map Set**  
 Blackwell Rd 230 kV Transmission  
 Line and Substation Project  
 Fauquier and Prince William  
 Counties, Virginia  
 Page 6








- Option 2, Overhead Route 1
- Option 2, Overhead Route 2
- Proposed Overhead Right of Way
- Parcel Boundary
- NHD Waterbody

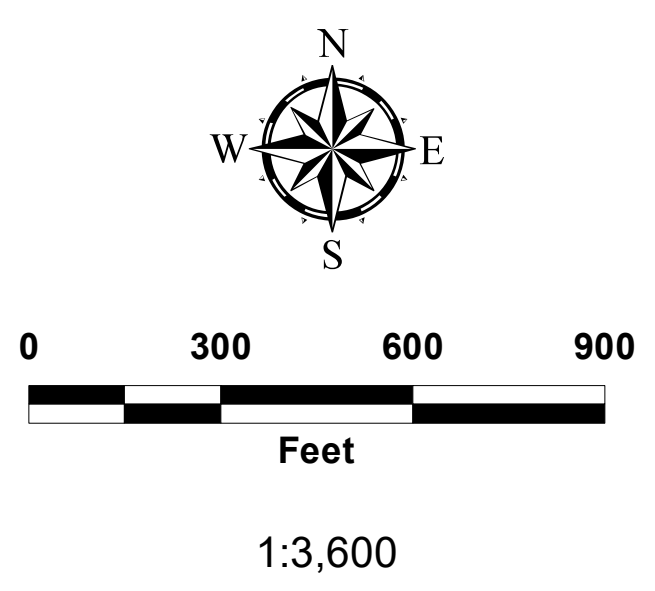
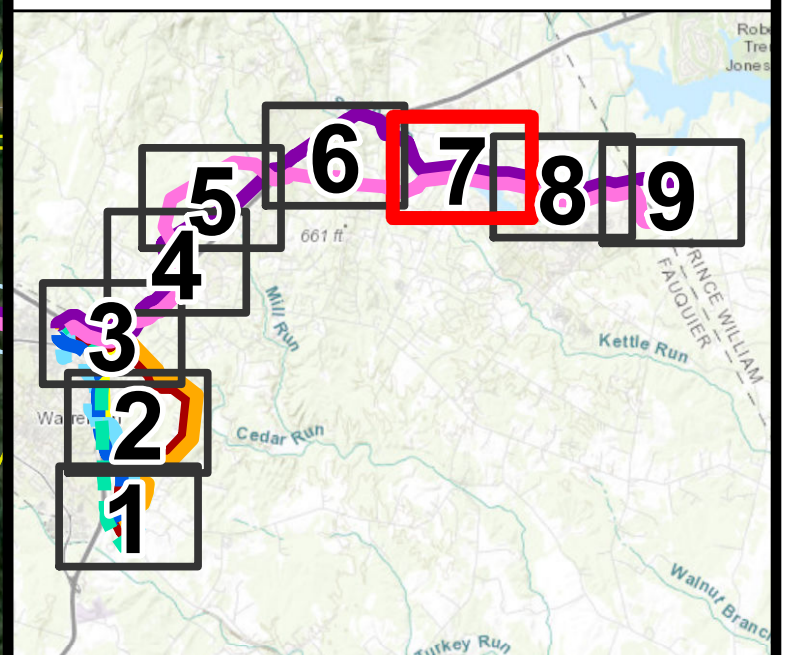




**Figure 2**  
**Parcel Map Set**  
 Blackwell Rd 230 kV Transmission  
 Line and Substation Project  
 Fauquier and Prince William  
 Counties, Virginia  
 Page 7



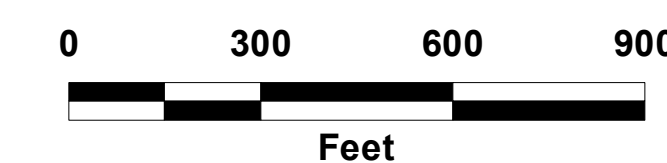
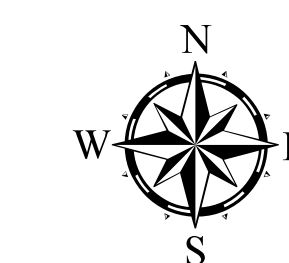
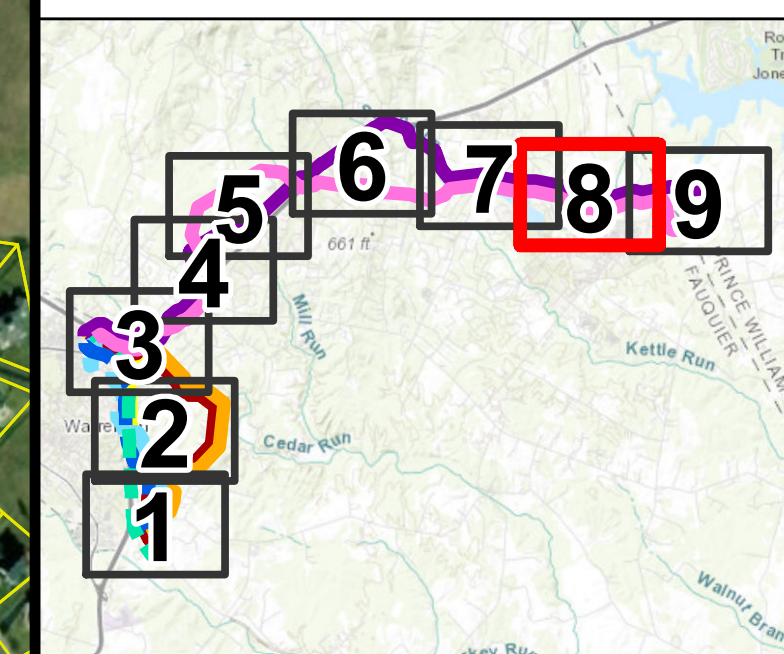
-  Option 2, Overhead Route 1
-  Option 2, Overhead Route 2
-  Proposed Overhead Right of Way
-  Parcel Boundary
-  NHD Waterbody





**Figure 2**  
**Parcel Map Set**  
 Blackwell Rd 230 kV Transmission  
 Line and Substation Project  
 Fauquier and Prince William  
 Counties, Virginia  
 Page 8

- Option 2, Overhead Route 1
- Option 2, Overhead Route 2
- Proposed Overhead Right of Way
- Parcel Boundary
- NHD Waterbody



1:3,600





**Figure 2**  
**Parcel Map Set**  
 Blackwell Rd 230 kV Transmission  
 Line and Substation Project  
 Fauquier and Prince William  
 Counties, Virginia  
 Page 9



- Existing Substation
- Option 2, Overhead Route 1
- Option 2, Overhead Route 2
- Proposed Overhead Right of Way
- Existing Dominion Transmission Line
- Parcel Boundary
- NHD Waterbody

